

14 Hasper Avenue, Withington, Manchester, M20 1AX



JP&Brimelow
ESTATE AGENTS

Offers In The Region Of £320,000



VIDEO TOUR AVAILABLE A delightful and well proportioned, THREE BEDROOM, Semi-detached property, located in the leafy Withington off Whitchurch Road. This traditional home is ideally located close to excellent transport links, offering easy access to Manchester City Centre and Manchester Airport, with Hough End Playing Fields and Hough End Leisure Centre right on your doorstep. The well-designed accommodation comprises an entrance hall, a spacious lounge, a downstairs W.C. and a fitted kitchen/diner with garden views and direct access to the enclosed rear garden, along with a useful storage cupboard completing the ground floor. To the first floor, the landing leads to two generous double bedrooms, a third bedroom, and a modern three-piece bathroom suite, completing this charming home. The property further benefits from gas-fired central heating, an enclosed rear garden, and a shared driveway.





EPC Chart

Energy Efficiency Rating		
	Current	Potential
Very energy efficient - lower running costs		
(92 plus) A		
(81-91) B		
(69-80) C		
(55-68) D		
(39-54) E		
(21-38) F		
(1-20) G		
Not energy efficient - higher running costs		
England & Wales	EU Directive 2002/91/EC 	



Tenure: **Leasehold** Council Tax Band: **C**

Ground Floor

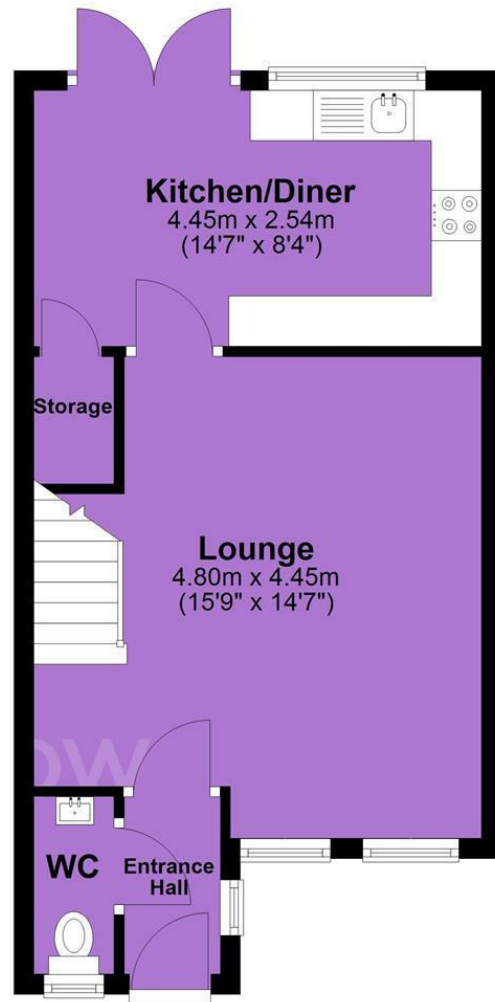

First Floor

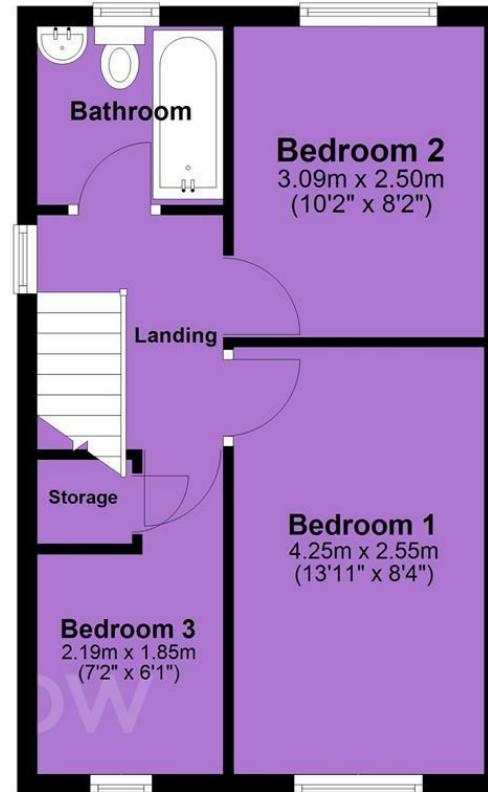

JP & Brimelow Estate Agents Ltd
430 Barlow Moor Road, Manchester, M21 8AD
Tel: 0161 8822233
E: sales@jpbrimelow.co.uk www.jpandbrimelow.co.uk



JP & Brimelow
ESTATE AGENTS

NOTICE: JP & Brimelow Estate Agents Ltd for themselves and for the vendors or lessors of this property whose agents they are give notice that:

- (i) the particulars are set out as a general outline only for the guidance of intending purchasers or lessees, and do not constitute, nor constitute part of, an offer or contract;
- (ii) all descriptions, dimensions, references to the condition and necessary permissions for use and occupation, and other details are given in good faith and are believed to be correct but any intending purchasers or tenants should not rely on them as statements or representations of fact but must satisfy themselves by inspection or otherwise as to the correctness of each of them;
- (iii) no person in the employment of JP & Brimelow Estate Agents Ltd has any authority to make or give any representation or warranty whatever in relation to this property.

@jpandbrimelowstateagents

@jpandbrimelow